



**ROAD TRAFFIC REGULATION ACT 1984 - SECTIONS 64 AND 65
AUTHORISATION OF TRAFFIC SIGNS AND SPECIAL DIRECTIONS**

The Secretary of State for Transport, in exercise of his powers under Sections 64 and 65 of the Road Traffic Regulation Act 1984, and of all other powers enabling him in that behalf, for the purpose of assisting in the free flow of vehicular traffic at the junction of Gunnersbury Lane, Gunnersbury Avenue, and Pope's Lane, hereby:-

1. authorises the placing at or within the vicinity of the site indicated schematically in the attached plan numbered GT50/139/0099-1 of a traffic sign consisting of a road marking (hereinafter referred to as "the authorised marking") conforming as to size, colour and character with that shown in diagram 1043 in Schedule 6 to the Traffic Signs Regulations 2002 (Part I of SI 2002/3113, "the 2002 Regulations"), save that the overall shape of the authorised marking shall be as shown in the said plan; and
2. directs, without prejudice to any statutory provisions to the like effect, that it is a condition of this authorisation that the placing of the authorised marking at or near the said site shall continue to have effect only until such day as may be appointed by one month's notice given by the Secretary of State in writing to the traffic authority for the removal or alteration of the authorised marking and on that day the said authorisation shall, without prejudice to the giving of any further authorisation or direction, cease to have effect.

Section 36 of the Road Traffic Act 1988 shall apply to the authorised marking as it applies to the marking shown in diagram 1043 in Schedule 6 to the 2002 Regulations.



Department
for Transport

GT50/139/0099

The provisions of Regulations 12 and 31 of the 2002 Regulations shall apply to the authorised marking in the same manner as they apply to the marking shown in diagram 1043 in Schedule 6 to the 2002 Regulations.

Dated 14 March 2013

Signed by authority of the Secretary of State



.....
A Delegated Official of the Department of Transport

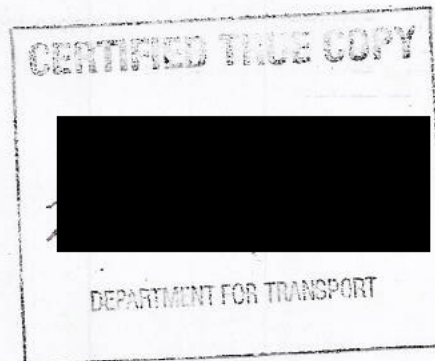

15/3/13



A406 GUNNERSBURY AVENUE

A4000 GUNNERSBURY LANE

POPE'S LANE

142

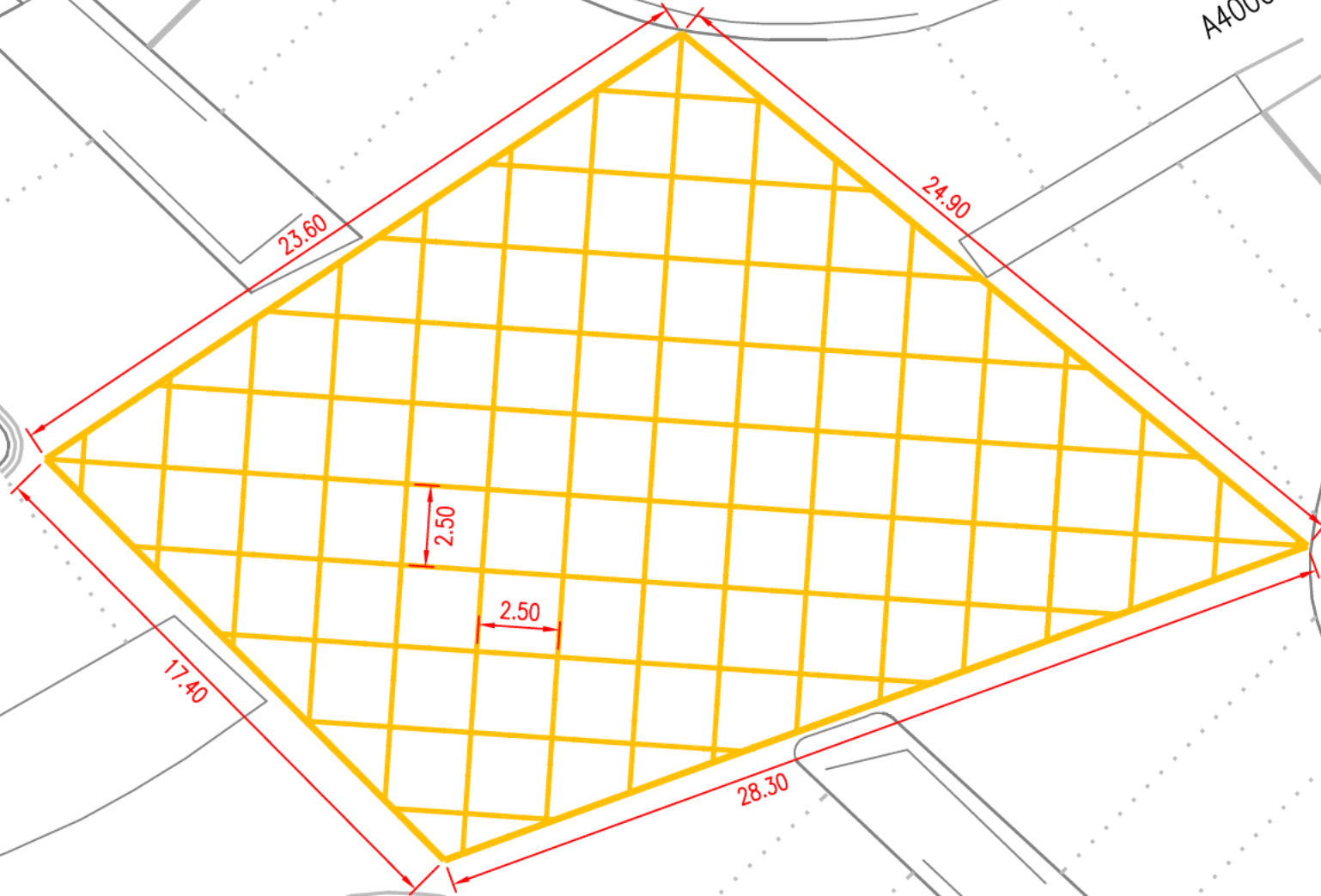

KEY:

- PROPOSED YELLOW BOX JUNCTION (TSRGD No. 1043)
- EXISTING ROAD MARKINGS

NOTES:

1. THICKNESS OF THE DIAGONAL YELLOW BOX LINES: 150mm
2. THICKNESS OF THE YELLOW BOX BOUNDARY LINES: 200mm
3. YELLOW BOX MARKINGS DOES NOT OVERLAP ANY OTHER ROAD MARKING

Surface Transport	scale	A3	date	MS	PR	SW
	1:200	©	01.03.13	drn	eng	chk

Roads Directorate
Traffic Design Engineering
Palestra
197 Blackfriars Road
LONDON SE1 8NJ

scheme LB OF EALING
GUNNERSBURY AVE / LANE jw
POPE'S LANE
YELLOW BOX JUNCTION
PROPOSED LAYOUT

NO TDE-YBJ650-IN-03

This map is reproduced from Ordnance Survey material with the permission of Ordnance Survey on behalf of the Controller of Her Majesty's Stationery Office © Crown copyright. Unauthorised reproduction infringes Crown copyright and may lead to prosecution or civil proceedings. (100035971) (2011).