



Northern Line Extension

Kennington Green

Community Liaison Group 23.03.15



Summary Update



- Enabling works at all four sites, including Kennington Green have started
- Main works due to start during 2015 following approval of Code of Construction Practice Part Bs (CoCP B)
- Ongoing engagement with third parties



NLE Project Draft timetable

Year	Key milestones
2014	Transport and Works Act Order decision, Design & Build contract signed
2015	Agreement on Code of Construction Practice Part B, Start of main works at all sites
2016	Launch of Tunnel Boring Machines
2017	Completion of tunnelling
2018	Fit out of new stations, Kennington shafts complete inc reinstatement, work at Kennington station complete
2019	Testing, commissioning, trial operations
2020	NLE complete and in service

Kennington Green Update



Period	Key milestones
Feb – Jun 15	<ul style="list-style-type: none">• Site Clearance and site set up• Montford Place support site set up• Temporary Fencing installed at Kennington Green• Completion of installation of new power supply• Archaeological Surveys• Tree Lopping/Removal / Protection works• Bus lane suspension at Kennington Green• Utility Service Diversions by BT, Virgin, Gas and Water• UXO Probing Kennington (Unexploded Ordnance) Radar detection from ground level• Installation of permanent hoarding to be completed



Ground Investigation

- The NLE team is approaching completion of what is called concept design
- Ground conditions for tunnelling predominantly London Clay. An ideal tunnelling medium
- Groundwater/ step plate junction within a full face of impermeable London Clay
- Requirements for additional boreholes is being reviewed
- Arrangement for archaeological works are being progressed
- Update on design proposals replacing the need for compensation grouting

Preliminary Settlement Contours

Kennington Green

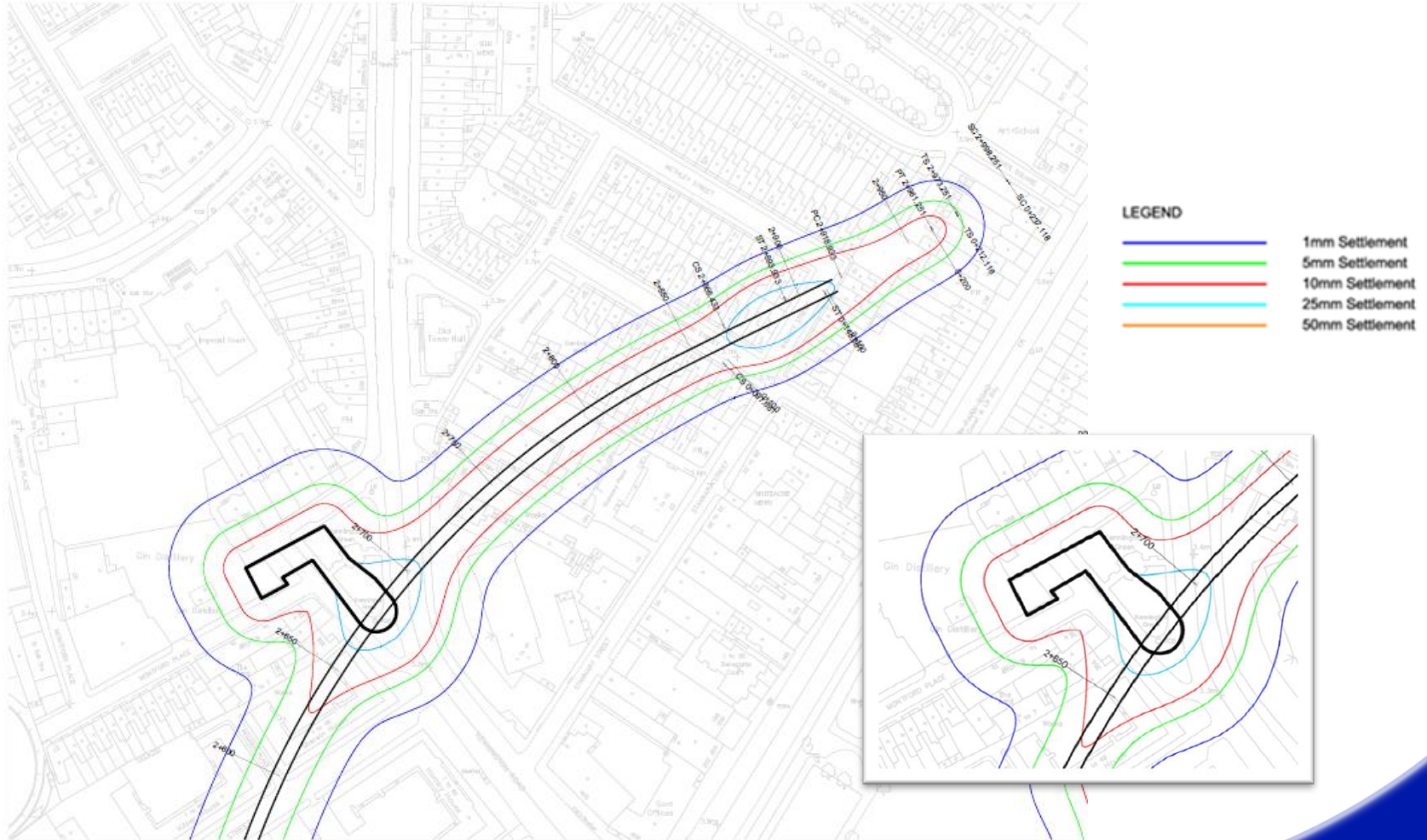

Defect Surveys

- Defect Surveys to be undertaken by a qualified chartered building surveyor or engineer on properties predicted to experience 1mm or more settlement as per LU standards
- Defect Surveys around shafts commence in June to ensure that the surveys are undertaken within 6 months of piling works programmed for August 2015
- Defect Surveys in areas of Spray Concrete Lining (SCL) works and Step Plate Junctions to be undertaken at a later date in advance of construction (second half of 2016 and first half of 2017)

Defect Surveys

- A minimum of 4 weeks notice will be given to building owners prior to the defect survey being carried out
- Where necessary a second survey will be undertaken to establish the difference between the two assessments
- There will be a written and photographic record and a copy will be available to the property owner

Settlement Deeds

- TfL has started contacting properties via letter about settlement deeds
- Settlement deeds to be offered to property owners where the property falls within the NLE Limits of Deviation
- A further letter with a Frequently Asked Questions document is being sent out

Measuring & Monitoring



- Outline design for monitoring completed January 2015
- Consultants working on the detailed monitoring scope
- Monitoring tender package to be awarded end of March
- Monitoring installation to begin May-June 2015
- Minimum of 4 weeks notice will be given to building owners prior to the installation of any monitoring equipment to buildings
- Envisaged that the monitoring equipment will comprise BRE (building research establishment) studs (structure levelling studs) and 3D geodetic prisms, see next slides



Monitoring techniques

Buildings – Real time data:

3D geodetic prisms



Automatic Total Station (ATS)



Prisms

ATS: an electrical/optical instrument used in modern building construction to measure slope distances from the instrument to a particular point.



Monitoring techniques

Buildings – Manual data:

BRE studs (structure levelling studs)



Code of Construction Part B



- CoCP B have been updated with comments from December drop in sessions as appropriate
- Individual response to feedback to be sent imminently
- CoCP B submitted to London Borough of Lambeth for discharge of planning condition in January 2015.
- Awaiting approval
- Saturdays quiet working hour, 0800 to 0900 agreed with Lambeth



Construction Noise Assessment

- Enabling works have been assessed using the NLE construction noise and vibration mitigation scheme and no properties were found to be above the threshold for secondary glazing or temporary re-house
- Noise modelling is being updated from the Environmental Statement, to include more detailed construction methodologies and mitigation measures for the duration of the scheme
- Predictions will be reviewed on a 6 monthly basis to capture any design changes
- Best Practicable Means will be applied to mitigate noise at source

Acoustic Enclosure Kennington Green

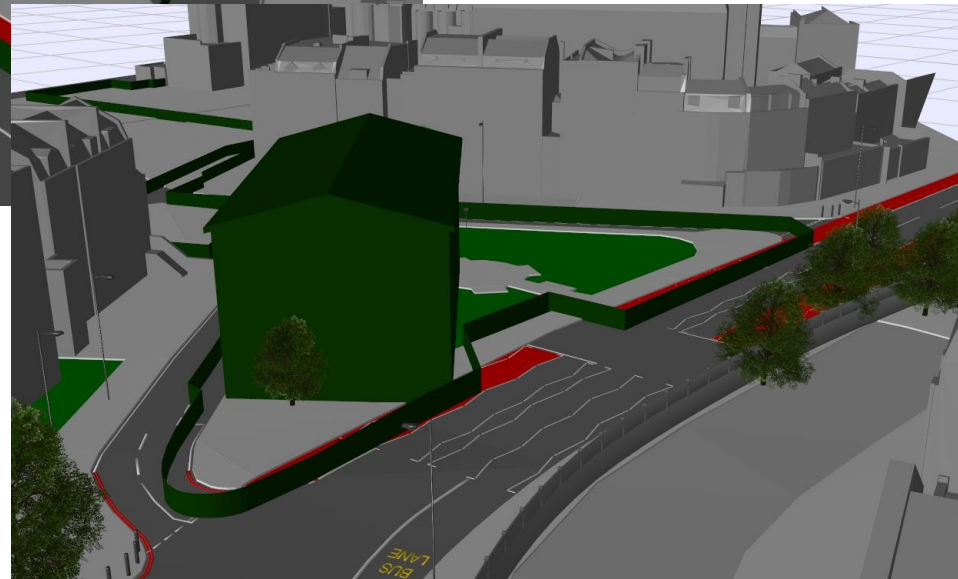
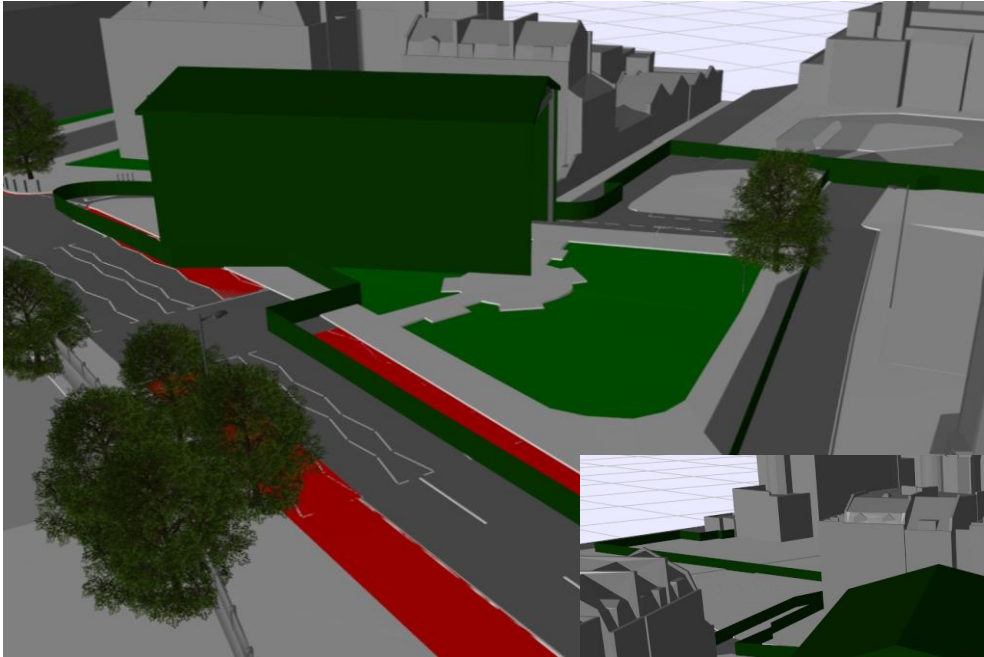

Hoardings at Kennington Green

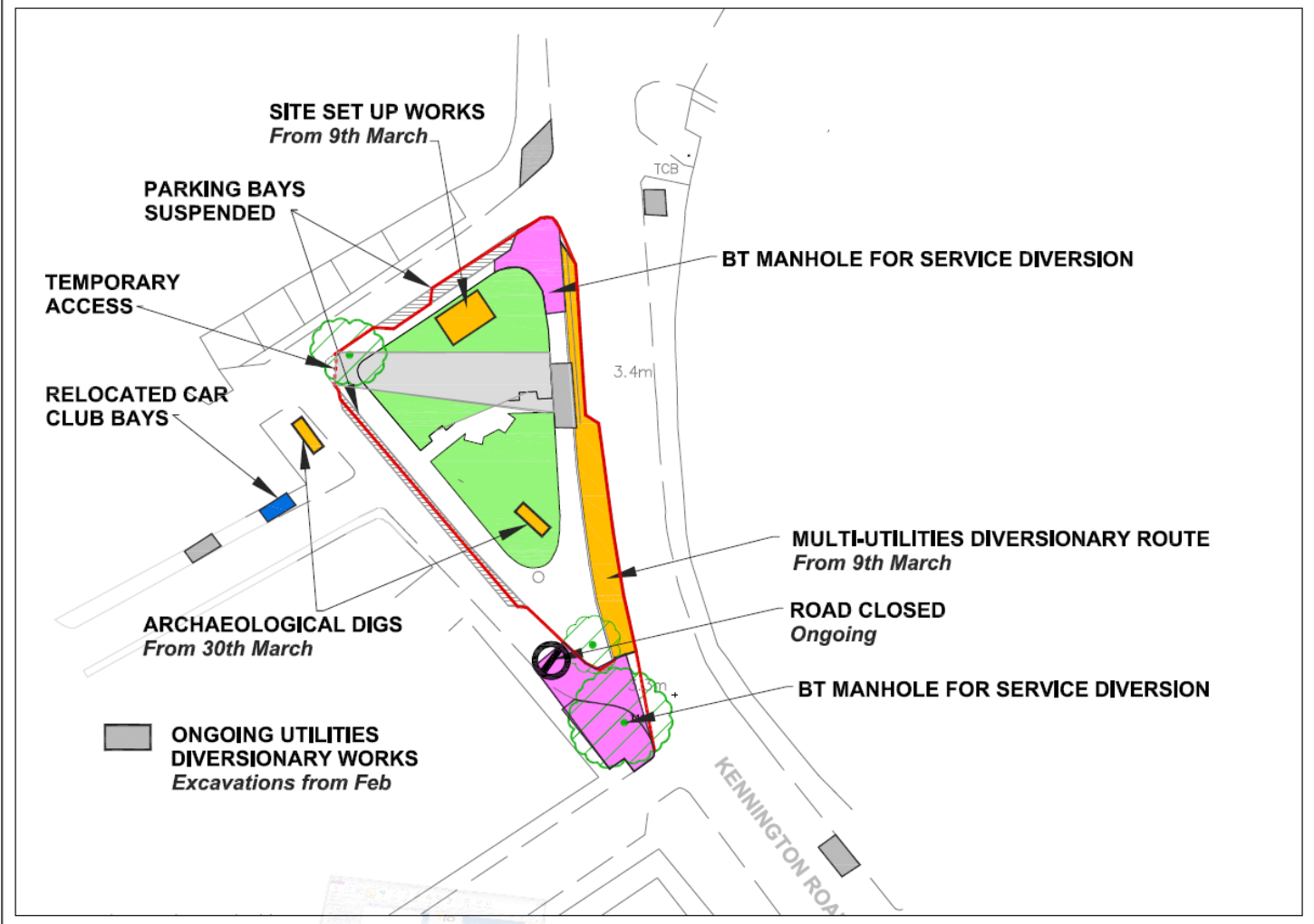

KG Traffic Management Plans

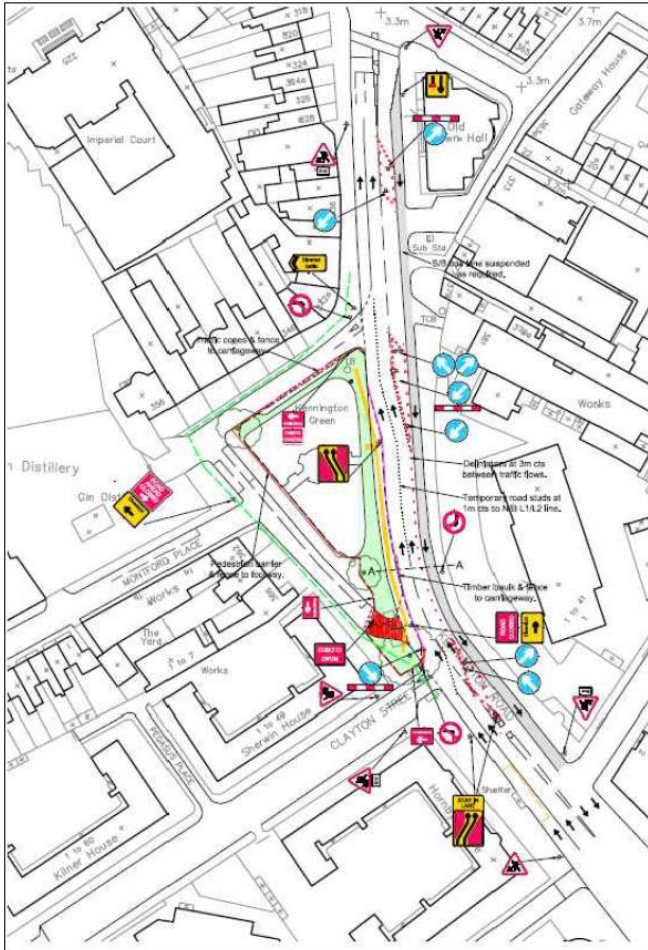

- Traffic coming out of KG is only turning left
- Kennington Road reduced to two lanes at Kennington Green
- Pedestrian access routes are under review
- Montford Place access restricted



NLE Complaints / Enquiries Summary



- Complaints received from January 15 – March 15

Date	Organisation	Address	Details of complaint	Response	Status
08/01/2015	Resident	Kennington Road	Reported wrong tree removal notifications at Kennington Green	Lambeth is dealing with the mistake at Lambeth and referred to the tree officer at Lambeth. Notification removed from incorrect tree.	Closed
16/01/2015	Resident	Imperial Court	Noise and nuisance near her property	Not related to our works, Chivas. Dealt within 24h. Though her initial contact was December 2014 Meeting held with resident and representative. Resident satisfied with outcomes.	Closed
26/01/2015	Resident	Kennington Road	Plants outside the green being removed.	The plants were removed by LBL and with no possibility of being reinstalled	Closed
22/01/2015	Resident	Imperial Court	Hoardings around the Montford Place site	Two visits have been held with resident and solutions are being investigated.	Closed
13/02/2015	Resident	Kennington Road	Complaint about the relocation closure of the Post box by the Green	The post box have been relocated to a nearby location. Resident was satisfied with how the complaint was dealt with	Closed
24/02/2015	Resident	Ravensdon Street	Enquiry about grouting, defect surveys and deeds and date of CLG clashing with residents association meeting	Email was sent to resident addressing her enquiry. She was satisfied with response	Closed
06/03/2015	Resident	Kennington Road	Enquiry about a broken bollard outside Kennington Road	The bollard was reinstated within 1 days. Traffic Management in pace	Closed





NLE Complaints / Enquiries Summary

- Complaints received from January 15 – March 15

Date	Organisation	Address	Details of complaint	Response	Status
09/03/2015	Resident	Montford Place	Complaint about vehicle exit safety at Kennington Green	Netting around the fencing was removed to improve visibility	Closed
17/03/2015	Resident	Montford Place	Vehicle passing at Montford Place	Visit to resident and brief to subcontractor to avoid future occurrence	Closed
17/03/2015	Resident	Kennington Rd	Night work around Kennington Green in two occasions during March	First report unable to clarify whether NLE was responsible for the works, second report confirmed and subcontractor has been re-briefed and made aware of CoCP B requirements.	Open
17/03/2015	Residents	Montford Place and Kennington Rd	Complaint about damage to trees at Kennington Green	An arboricultural specialist has been instructed to carry out an assessment.	Open
March 2015	Residents	Route Wide	A number of complaints and enquiries have arrived to NLE regarding clarity of settlement deeds letter sent March 13	A second letter is to be sent out imminently with FAQ's and the timescales for replies extended	Open

Updates and newsletters

- Updated activity notification were sent to residents on February 12 and March 6 2015
- An updated monthly activity is to be sent out end of March.
- NLE quarterly Newsletter delivered March 2015

**Northern line extension
ACTIVITY NOTIFICATION** 06 March 2015

Kennington Green – site set up

We would like to advise you of some changes you will start noticing from Saturday 07 March. The pedestrian crossing adjacent to the Green will be suspended because of the bus lane and pavement closure along Kennington Rd. We will be erecting temporary fencing around the Green. This is to ensure archaeological surveys and site set up is carried out safely. A more permanent hoarding will be erected after the utilities diversions are completed, the design of which will be sympathetic to the environment. Utilities subcontractors BT and UKPN are currently undertaking utilities diversion in areas shown on the diagram below. A number of parking bays on Kennington Rd need to be suspended and the Royal Mail box on the corner of the Green is to be relocated to a position near the 'Cleaner London' business. All works will take place between **Monday to Friday 08:00 to 18:00 and on Saturday from 08:00 to 13:00.**

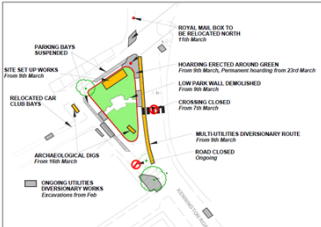

Thank you for your patience while we continue with the setting up of the Kennington Green site in your area. We will endeavour to minimise disturbance and will manage the work in accordance with the Code of Construction Practice, including the control of noise, vibration and dust using best practicable means. A temporary traffic management plan will be implemented to enable these changes to take place.

If you have any concerns or queries, please contact us at nle@tfl.gov.uk or call our 24/7 helpdesk on 0343 222 2424

Ref: FLO-N143-2360000-COM-NTF-00002

nle@tfl.gov.uk
 0343 222 2424
tfl.gov.uk/northern-line-extension

Transport for London



Northern line extension

March 2015

Boosting jobs in the local economy



Careers expo at South Bank University

The Northern line extension will support the regeneration of Vauxhall, Nine Elms and Battersea and help create up to 25,000 jobs and 18,000 homes.

Local jobs and apprenticeships are a key priority. We have spoken with local authorities, job brokering and our supply chain to staff the construction of the Northern line extension. The project will support around 1,000 jobs and 50 apprenticeships.

Our contractor Ferrovial Agroman Laing O'Rourke (FLO) will have a team of around 500 people at the busiest period of construction.

We recently attended a careers expo at South Bank University where Wandsworth and Lambeth school and college students were able to find out about career opportunities and apprenticeships. We also attended a similar event for students in Southwark and Lambeth at Goldsmith's University of London.

MAYOR OF LONDON



Consents



Approvals granted

Planning Condition 5 - removal of trees at Kennington Green and Kennington Park	L B Lambeth	Granted February 2014
Nine Elms Section 61 Consent (Control of Pollution Act – noise and vibration)	L B Wandsworth	Granted February 2014
Battersea Section 61 Consent (Control of Pollution Act – noise and vibration)	L B Wandsworth	Granted February 2014

Current applications under determination

All sites – application to discharge planning condition 10 - Archaeology	LB Lambeth and LB Wandsworth	Submitted February 2015
All sites – application to discharge planning condition 7 – CoCP pt B	LB Lambeth and LB Wandsworth	Submitted January 2015
Kennington Park, Kennington Green – applications for a Section 61 consent under the Control of Pollution Act - the minimisation of construction noise and vibration	LB Lambeth	Submitted March 2015



Consents (continued)



Current applications under determination

Kennington Park - application to discharge planning condition 18 – yellow hatched box junction – Kennington Park Place/Road	LB Southwark	Submitted January 2015
Kennington Park and Kennington Green – application to (initially) discharge Conservation Area Consent condition C (reinstatement)	L B Lambeth	Submitted January 2015
Nine Elms and Battersea - application to discharge planning condition 9 – Contaminated Land	LB Lambeth and LB Wandsworth	Submitted February 2015
Battersea – applications for approvals under Schedule 8 (Protective Provisions) of the TWAO – works within the river.	Marine Management Organisation	Submitted March 2015

Key forthcoming applications for approval

Battersea – applications for approvals under Schedule 8 (Protective Provisions) of the TWAO – works within the river.	EA, PLA	Planned be submitted March 2015
Kennington Station - application to discharge planning condition 19 – Kennington Station passenger flow monitoring protocols	LB Southwark	Planned be submitted early 2015 (direct by TfL)
Kennington Park and Kennington Green - application to discharge planning condition 9 – Contaminated Land	LB Lambeth	Planned be submitted March 2015



Jobs and apprenticeships



TfL's existing programmes

- Skills & Employment Strategy, Delivery Plan for Schools and Young People

Employment/Skills/Diversity on the NLE programme

- FLO is working in partnership with TfL and the local authorities – including the Nine Elms Vauxhall Strategy Board Employment, Training & Business Charter, Wandsworth Chamber of Commerce and Nine Elms Supply Chain
- Make sure employment/training opportunities are advertised within the job opportunity/brokerage schemes operated by Southwark, Lambeth & Wandsworth councils
- Encourage job starts for workless people in London, placement & taster positions, apprenticeships, skills development for staff, engagement with schools
- A Strategic Labour Needs and Training Plan is being developed with Local Authorities



Jobs and Business Opportunities



- FLO attended a Lambeth organised “How to be the best bet for buyers” event
- 19 February 2015 at the Kia Oval
- This was to present opportunities at the NLE and procedures on how to enter for tender packages
- Small and medium businesses had the opportunity to meet with major contractors



Lambeth

How to be the Best Bet for Buyers

Where:
Kia Oval
Kennington
London SE11 5SS

When:
Thursday
19 February 2015
9am – 3pm

Do you want to...

- Hear about major vehicle maintenance contracts
- Network with other businesses to develop partnerships to bid for larger contracts?
- Get expert advice on preparing and submitting tenders?
- Find out about major developments and work packages available for local subcontractors?
- Sign up with major housing contractors looking to contract with local subcontractors?
- Network with potential clients?

Where:
Hear from developers looking to work with businesses like you. Hear from industry experts and get free advice from the many exhibitors attending on the day. From understanding the pre-qualification process including health and safety, to financing major contract wins, to recruitment/employment, to gearing up to taking on large contracts. Throughout the day you will have the opportunity to speed network with other businesses and speak to exhibitors about live contracts and what you need to do to win that contract.

Programme

9.00am	Event opens and registration
9.15am	Cllr Jack Hopkins – Cabinet Member for Jobs and Growth
9.30am	Introducing South London Procurement Network
9.45am	Break – Attendees visit exhibitor stands
10.30am	Introducing Lambeth Procurement
11.00am	Julie Harmer – Member of CIPS
11.15am	Break – Attendees visit exhibitor stands
12.00pm	Lunch and Networking
1.00pm	Mears Group – How to win that contract
1.15pm	Break – Attendees visit exhibitor stands
1.30pm	Ferrovial Agroman Laing O'Rourke (FLO)
1.45pm	Break – Attendees visit exhibitor stands
2.00pm	St. James/Berkeley Group
2.15pm	Networking
2.00pm	Close

South London Procurement Network

To confirm your attendance please email info@slpn.org.uk with company and attendee's names.



Skills and Youth Engagement



Careers Expo for students 4-5 March, at Goldsmith University



- Co-ordinated by Southwark Council.
- Hosted at Goldsmith University NLE in attendance at the event.
- More than 150 students attended NLE workshop.
- Encourage young people to consider construction as professional option.
- Promote the NLE benefits and awareness amongst young people.



Community engagement strategy



- Draft Strategy discussed at the June – July cycle of CLG's
- Core CLG received all comments made
- Strategy and site specific engagement forecast tabled
- Southwark Career Expo March 2015.
- **6 months look ahead includes:**
- Preparation and approval of a SLNT Plan.
- Preparation and approval of Youth and School Engagement Plan
- Preparation and approval of a Arts and Culture Strategy
- Activities around all four sites to ensure communication and engagement: Drop in sessions / Visits / Events / School Liaison



Thank you