



**ROAD TRAFFIC REGULATION ACT 1984 – SECTIONS 64 AND 65
AUTHORISATION OF TRAFFIC SIGNS AND SPECIAL DIRECTIONS**

The Secretary of State for Transport, in exercise of his powers under Sections 64 and 65 of the Road Traffic Regulation Act 1984, and of all other powers enabling him in that behalf, for the purpose of assisting in the free flow of vehicular traffic at the junction of Westthorne Avenue and Baring Road in the London Borough of Lewisham, hereby:-

1. authorises the placing at or within the vicinity of the site shown on the attached plan numbered GT50/139/0090-1 of a traffic sign consisting of a road marking (hereinafter referred to as "the authorised marking") conforming as to size, colour and character with that shown in diagram 1044 in Schedule 6 to the Traffic Signs Regulations 2002 (Part I of S.I. 2002/3113, "the 2002 Regulations"), save that the overall size and shape of the authorised marking shall be as shown on the said plan; and
2. directs, without prejudice to any statutory provision to the like effect, that it is a condition of this authorisation that the placing of the authorised marking at or near the said site shall continue to have effect only until such day as may be appointed by one month's notice given by the Secretary of State in writing to the traffic authority for the removal or alteration of the authorised marking and on that day the said authorisation shall, without prejudice to the giving of any further authorisation or direction, cease to have effect.

Section 36 of the Road Traffic Act 1988 shall apply to the authorised marking as it applies to the marking shown in diagram 1044 in Schedule 6 to the 2002 Regulations.



Department
for Transport

GT50/139/0090

The provisions of Regulations 12 and 31 of the 2002 Regulations shall apply to the authorised marking in the same manner as they apply to the marking shown in diagram 1044 in Schedule 6 to those Regulations.

Dated 27 March 2013

Signed by authority of the Secretary of State



A Delegated Official of the Department for Transport



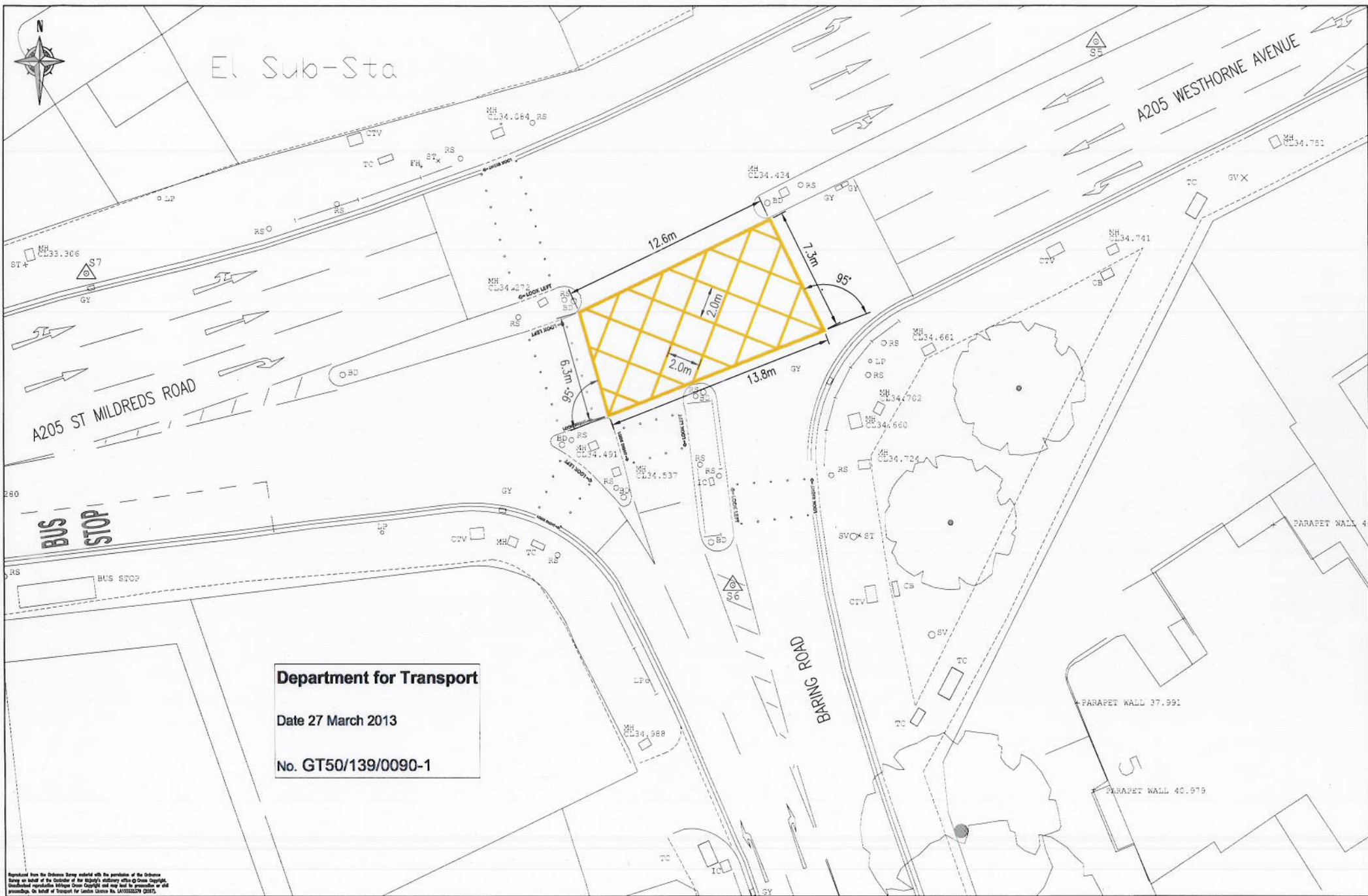

Department for Transport
 Date 27 March 2013
 No. GT50/139/0090-1

Derived from the Ordnance Survey material with the permission of the Ordnance Survey on behalf of the Controller of Her Majesty's Stationery Office. Crown Copyright. Reproduced with the permission of Her Majesty's Stationery Office. All rights reserved. On behalf of Transport for London Licence No. LA10003259 02017.

- KEY:**
- NEW YELLOW BOX JUNCTION (TSRD No. 1044)
 - EXISTING WHITE ROAD MARKINGS

- NOTES:**
1. ALL DIMENSIONS ARE IN METRES UNLESS OTHERWISE STATED.
 2. ALL ROAD MARKINGS TO BE IN ACCORDANCE WITH THE TRAFFIC SIGNS REGULATION AND GENERAL DIRECTIONS AND CHAPTER 5 OF THE TRAFFIC SIGNS MANUAL.
 3. THICKNESS OF THE DIAGONAL YELLOW BOX LINES IS 150mm.
 4. THICKNESS OF THE YELLOW BOX BOUNDARY LINES IS 200mm.
 5. YELLOW BOX MARKINGS DOES NOT OVERLAP ANY OTHER ROAD MARKING.

 Working with 	PROJECT A205-A20 YELLOW BOX MARKINGS	DRAWN BY: KL CHECKED BY: KL APPROVED BY: TH DATE: 14/11/12
	CLIENT BARING ROAD ROAD MARKINGS	PROJECT NUMBER: 1048251-IN-1200-001