



GT46/37/113

**ROAD TRAFFIC REGULATION ACT 1984 - SECTIONS 64 AND 65
AUTHORISATION OF TRAFFIC SIGNS AND SPECIAL DIRECTIONS**

The Secretary of State for Transport, in exercise of her powers under Sections 64 and 65 of the Road Traffic Regulation Act 1984, and of all other powers enabling her in that behalf, for the purpose of assisting in the free flow of vehicular traffic at the junction of Kingsland High Street, Stoke Newington Road, Shacklewell Lane and Crossway, for which Transport for London is the traffic authority, hereby:-

1. authorises the placing at or within the vicinity of the site shown on the attached plan numbered GT46/37/113(Pt5)-2 of a traffic sign consisting of a road marking A (hereinafter referred to as "the authorised marking") conforming as to size, colour and character with that shown in diagram 1043 in Schedule 6 to the Traffic Signs Regulations 2002 (Part I of SI 2002/3113, "the 2002 Regulations"), save that the overall shape of the authorised marking shall be as shown on the said plan; and
2. directs, without prejudice to any statutory provision to the like effect, that it is a condition of this authorisation that the placing of the authorised marking at or near the said site shall continue to have effect only until such day as may be appointed by one month's notice given by the Secretary of State in writing to the traffic authority for the removal or alteration of the authorised marking and on that day the said authorisation shall, without prejudice to the giving of any further authorisation or direction, cease to have effect.



GT46/37/113

The provisions of Regulations 12 and 31 of the 2002 Regulations shall apply to the authorised marking in the same manner as they apply to the marking shown in the said diagram 1043.

Dated *30 September*2008

Signed by authority of the Secretary of State

.....
A Grade 7 Official of the Department for Transport

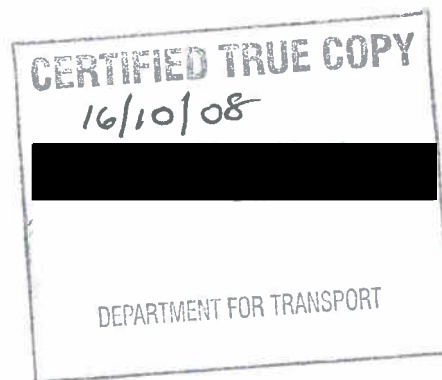

This page is reproduced from Ordnance Survey material with the permission of Her Majesty's Stationery Office.
 © Crown copyright
 Unauthorised reproduction in any form or by any means without the prior written permission of the Controller of Her Majesty's Stationery Office.
 (S/LA/100333/2/0000)

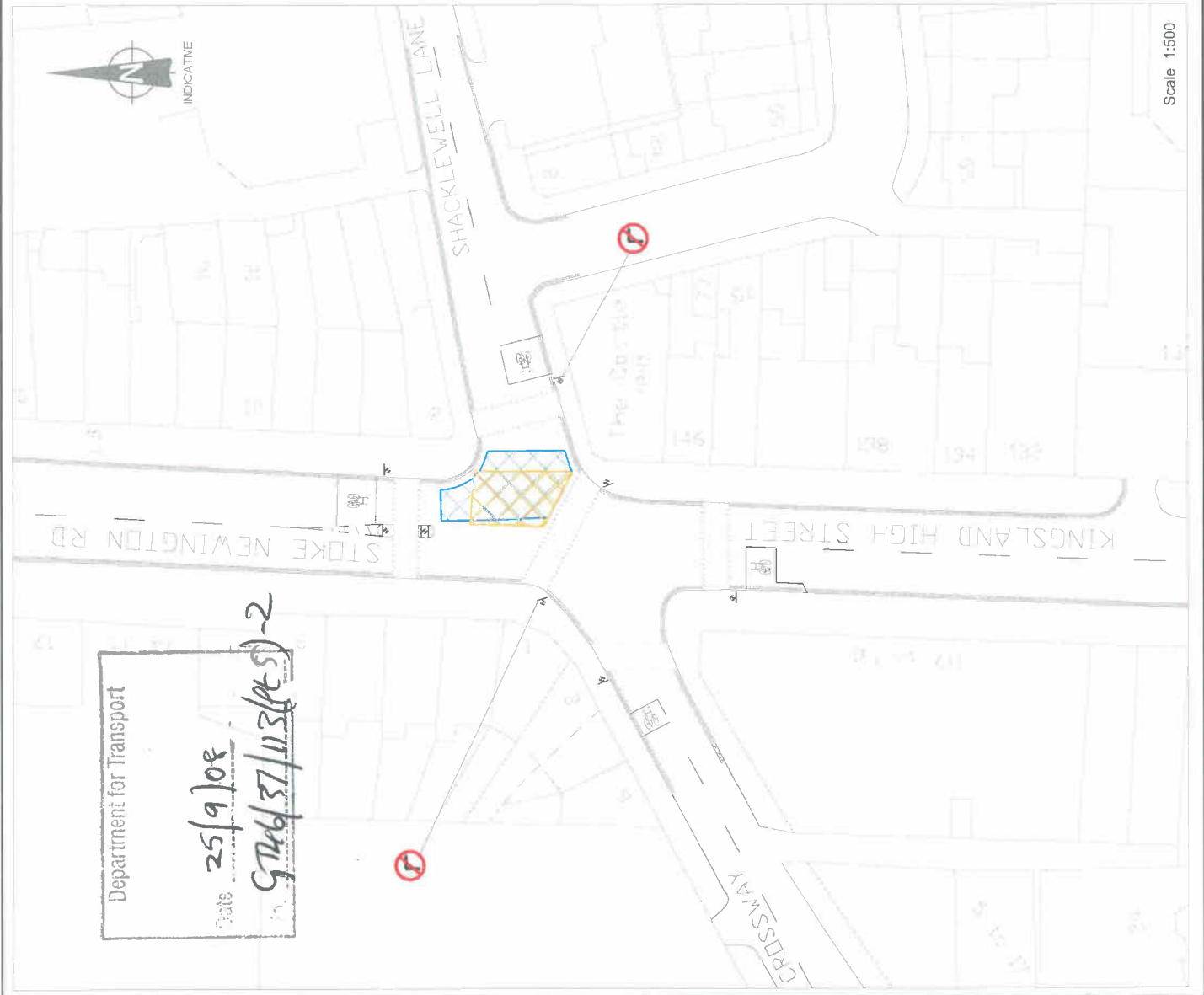

Department for Transport
 Date 25/9/08
 9746/37/113(PE5)-2

Scale 1:500

Existing Road Markings

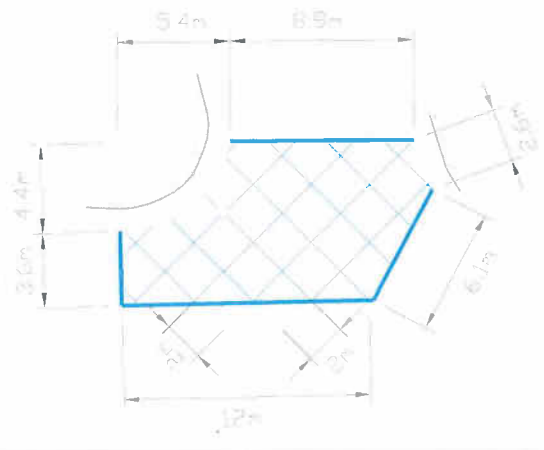

YBJ Boundary line thickness: 200mm
 YBJ Hatch line thickness: 150mm

Revised Road Markings

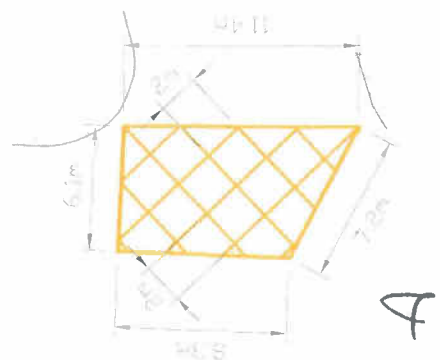

YBJ Boundary line thickness: 200mm
 YBJ Hatch line thickness: 150mm
 YBJ Hatch intersection: 90°

Scale 1:250

KEY



EXISTING YELLOW BOX JUNCTION



PROPOSED YELLOW BOX JUNCTION



Transport for London
London Streets

Street Management Services

Windsor House
 42-50 Victoria Street
 LONDON SW1H 0TL
 Telephone 020 7343 5000

TFL	NOTES	Date	Rev.	Int.

designed / drawn / traced	checked	approved	scale as shown	Original Sheet Size
RP	HKA	PC		A3
MAY '08	JUN '08	JUL '08		

PROJECT
 KINGSLAND HIGH ST, STOKES
 NEWINGTON RD, SHAKLEWELL
 LANE AND CROSSWAY
 REVISION OF YELLOW BOX
 JUNCTIONS

Drawing Status	
TFL DWG No.	HKNY_846_02
REV.	