



GT46/37/113

**ROAD TRAFFIC REGULATION ACT 1984 - SECTIONS 64 AND 65
AUTHORISATION OF TRAFFIC SIGNS AND SPECIAL DIRECTIONS**

The Secretary of State for Transport, in exercise of her powers under Sections 64 and 65 of the Road Traffic Regulation Act 1984, and of all other powers enabling her in that behalf, for the purpose of assisting in the free flow of vehicular traffic at the junction of Holloway Road, Drayton Park Road and Palmer Place, for which Transport for London is the traffic authority, hereby:-

1. authorises the placing at or within the vicinity of the site shown on the attached plan numbered GT46/37/113(Pt5)-3 of a traffic sign consisting of a road marking A (hereinafter referred to as "the authorised marking") conforming as to size, colour and character with that shown in diagram 1043 in Schedule 6 to the Traffic Signs Regulations 2002 (Part I of SI 2002/3113, "the 2002 Regulations"), save that the overall shape of the authorised marking shall be as shown on the said plan; and
2. directs, without prejudice to any statutory provision to the like effect, that it is a condition of this authorisation that the placing of the authorised marking at or near the said site shall continue to have effect only until such day as may be appointed by one month's notice given by the Secretary of State in writing to the traffic authority for the removal or alteration of the authorised marking and on that day the said authorisation shall, without prejudice to the giving of any further authorisation or direction, cease to have effect.



GT46/37/113

The provisions of Regulations 12 and 31 of the 2002 Regulations shall apply to the authorised marking in the same manner as they apply to the marking shown in the said diagram 1043.

Dated *30 September*2008

Signed by authority of the Secretary of State

.....
A Grade 7 Official of the Department for Transport



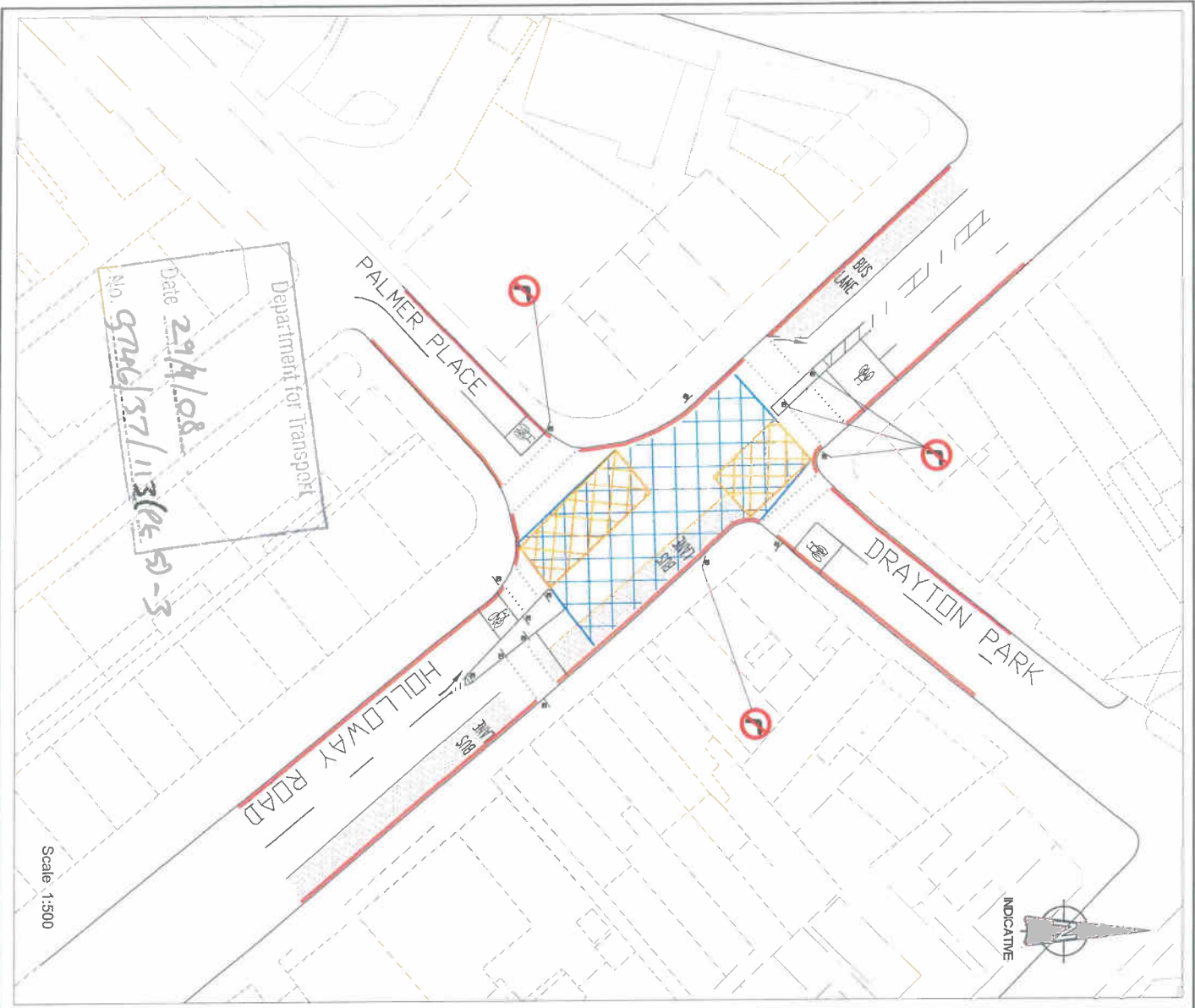

Existing Road Markings

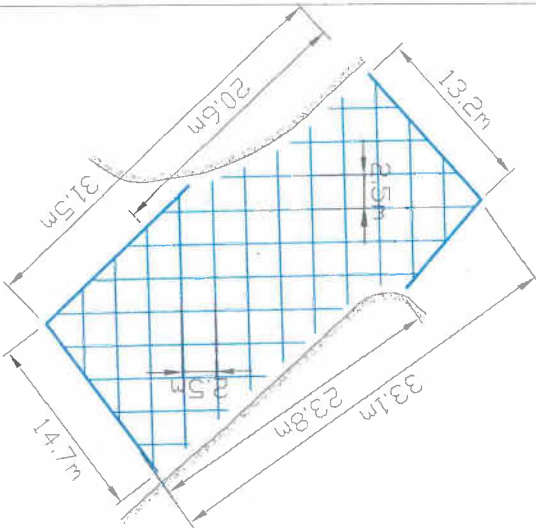

Revised Road Markings

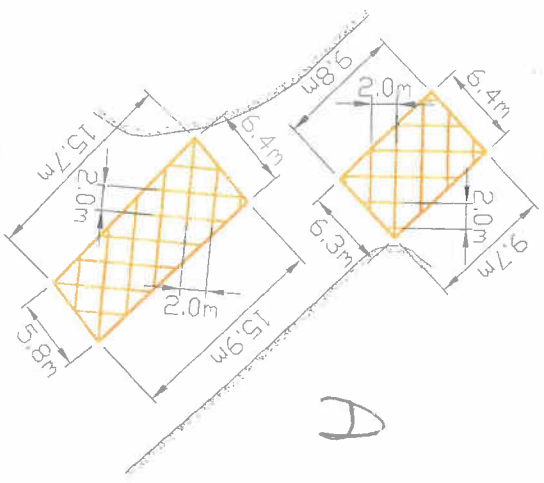

The new B Reproduced from Ordnance Survey, on behalf of the Controller of Her Majesty's Stationery Office.
 © Crown copyright
 Licensed under the Open Government Licence v1.0
 All rights reserved. No part of this publication may be reproduced, stored in a retrieval system, or transmitted in any form or by any means, electronic, mechanical, photocopying, recording, or by any information storage or retrieval system, without the prior written permission of the Controller of Her Majesty's Stationery Office.

KEY

- EXISTING YELLOW BOX JUNCTION
- PROPOSED YELLOW BOX JUNCTION



Street Management Services
 Windsor House
 42-50 Victoria Street
 LONDON SW1H 0TL
 Telephone 020 7343 5000

TEL

NOTES	Date	Rev.	Init.
Revisions			

designed			
drawn / traced	RP	JUN'08	
checked	HKA	JUL'08	
approved	PC	JUL'08	
scale as shown			Original Sheet Size A3

PROJECT
 HOLLOWAY ROAD, DRAYTON PARK ROAD AND PALMER PLACE
 REVISION OF YELLOW BOX JUNCTIONS
 OPTION 1

Drawing Status:
 TEL DWG NO. ISLG_594_02
 REV.

Scale 1:400